

SINGLE POINT

LOC Heavy Capacity

Aluminum, Environmentally Sealed, NTEP Certified 1:5,000 Class III Single Cell, IP65

Solo Basculas

SOLUCIONES DE PESO



Picture is a representation of actual product

Approvals



Order Information

Load Rating	Part #	Est. Weight	Price
100 kg	39797	7 lb	Consult
150 kg	39796	7 lb	Consult
250 kg	39795	7 lb	Consult
300 kg	39794	7 lb	Consult
500 kg	39793	7 lb	Consult

Dimensions

Rated Capacity	A	C	D	E	F	G	H
kg/mm							
100 to 500	191.0	25.0	11.0	82.0	60.0	5/16-18 UNC × 20 DP	75.0

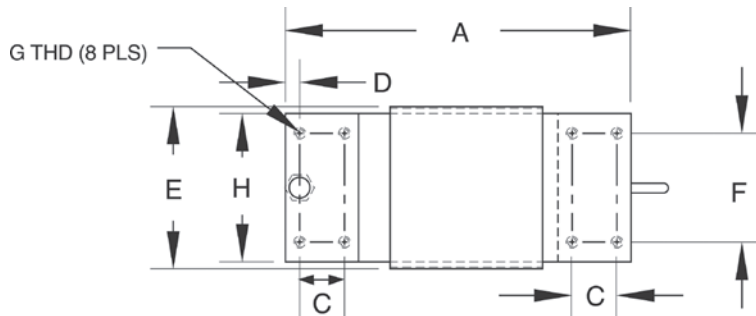

Specifications

- Full Scale Output:**
2.0 mV/V
- Output Resistance:**
350 (± 3) ohm
- Input Resistance:**
410 (± 10) ohm
- Material/Finish:**
Aluminum
- Temperature:**
Compensated range
14 °F to 104 °F (-10 °C to 40 °C)
Operating range
0 °F to 150 °F (-18 °C to 65 °C)
- Seal Type:**
Environmentally sealed, IP65
- Safe Overload:**
150% full scale
- Rated Excitation:**
5 to 10 VDC (15 V maximum)
- Combined Error:**
0.025% full scale
- Non-Repeatability:**
0.02%
- Insulation Resistance:**
5,000 megohm
- Cable Length:**
3 m
- Cable Diameter:**
0.200 in PVC jacket
- Cable Color Code:**
Red +Excitation
Black -Excitation
Green +Signal
White -Signal
- Max Platform Size:**
24 × 24 in
- Warranty:**
One-year limited
- Approvals:**
cFMus
NTEP