



Picture is a representation of actual product.

Order Information

Load Rating	Part #	Est. Weight	Price
1,000 lb	168114	5 lb	Consult
5,000 lb	168115	5 lb	Consult
10,000 lb	168116	7 lb	Consult
15,000 lb	168117	7 lb	Consult
20,000 lb	168118	7 lb	Consult
25,000 lb	168119	7 lb	Consult
50,000 lb	168120	33 lb	Consult

Dimensions

Rated Capacity lb/in	A1	A2	C	D	E	F	G
1,000 to 5,000	0.50	1.25	1.25	1.25	7.50	6.25	0.69
10,000 to 25,000	0.81	1.99	1.44	1.94	8.75	7.50	0.96
50,000	1.31	3.00	2.44	2.94	13.50	11.50	1.50

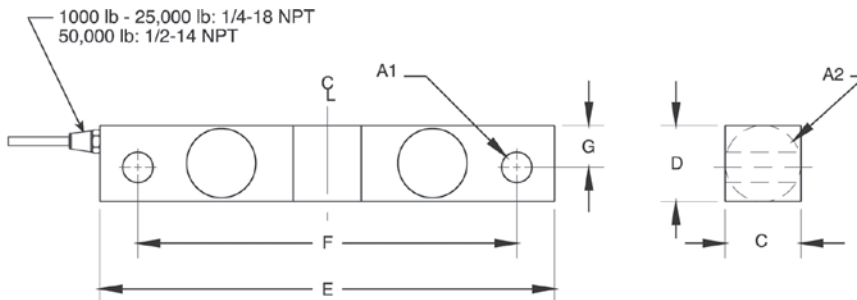

Interchangeable Products

RICE LAKE WEIGHING SYSTEMS

RL75016SS..... page 133

RICE LAKE WEIGHING SYSTEMS

RL75016WHE..... page 135

Specifications

Full Scale Output:

3.0 mV/V

Output Resistance:

700 (± 5) ohm

Input Resistance:

770 (± 10) ohm

Material/Finish:

Stainless steel

Temperature:

Operating range
0 °F to 150 °F (-18 °C to 65 °C)

Seal Type:

Welded-seal, IP67

Safe Overload:

100% full scale

Rated Excitation:

5 to 10 VDC (15 V max)

Hysteresis:

0.02% full scale

Linearity:

0.03% full scale

Cable Length:

25 ft

Cable Color Code:

Red +Excitation
Black -Excitation
Green +Signal
White -Signal

Warranty:

Two-year limited